



bowling  
furniture.com

# FURNITURE LOOKBOOK

# Table of Contents

01 About Us

- 02 Services
- 03 Product Quality
- 04-05 Custom Capabilities
- 06 Custom Projects
- 07 Value Engineering

08-21 Bowling Sofas

22-24 Ball Racks

25-32 Upholstered Sofas & Chairs

33-38 Ottomans & Benches

39-42 Booths & Banquettes

43-46 Tables

47-52 Chairs & Barstools

- 49-50 Metal Chairs & Barstools
- 51-52 Wood Chairs & Barstools

53-56 Outdoor

57-58 Millwork

## Our Story

Founded at the end of 2007, with just a handful of opportunities in a recessed economy, Venue Industries built a client base by providing value, unparalleled customer service and quality products. We have grasped tightly to these core principals and they still come through in everything that we do today. The strong foundation that we have built has afforded us the opportunity for exponential growth in both sales and in-house manufacturing capabilities. Today we build furniture for all commercial markets and our custom-built products, offered at extremely competitive prices, fuels our continued growth.



**Chuck Courter**  
President

Chuck grew up in New Jersey with quite a lot of entrepreneurial spirit. When he was only 15, he started his first job working for a commercial carpet cleaning company. Little did he know, those same offices and public spaces he cleaned - he would one day manufacture furniture for. Chuck started his own construction business at 20, before expanding into real estate and eventually furniture manufacturing. When he is not hard at work, he is flying high - literally. Chuck has his pilot's license, and spends his weekends with his family in the sky.



**Kelsey Scholl**  
Executive Vice President

Kelsey is a Tampa native with a degree in interior design. You could say she's kind of a "daddy's girl", inheriting her love for design from her architect father. From an early age, she accompanied him on trips to Home Depot or into the office, and even drew up floor plans for her future dream home. Kelsey now spends her time remodeling her actual "dream home" with her husband, two children, and their dog, Huntington.

# UNPARALLELED SERVICE

PRODUCT DESIGN

SPACE PLANNING

DEALER & DESIGNER  
SUPPORT

LOGISTICS &  
PROJECT COORDINATION

THOUGHTFUL  
EXECUTION

IN-DEPTH  
CUSTOMER SERVICE



# BUILT-TO-LAST PRODUCTS

CNC ROUTER CUT  
COMPONENTS

PREMIUM QUALITY  
RAW MATERIALS

BUILT TO BE  
SERVICED

SUPERIOR FIT &  
FINISH

METAL TO METAL CONNECTED  
WOOD COMPONENTS

DIVERSE PRODUCT MIX



# WELCOME TO GETTING *EXACTLY* WHAT YOU WANT.

We know specifying custom products can be tricky. That's why we offer a limitless supply of options to choose from, product design, and competitive pricing. We have the capabilities to design a vast array of products (we are not limited to the product types we already offer as standards) – so go ahead, dream big.

We're here to make the specifying process as seamless as it can be. Got logistical hiccups? Using us as your sole manufacturer instead of multiple sources will ease the entire process, including the logistics burden. We can ship everything on one truck and have it show up all at once - making the reception & installation of the project much smoother.

Value engineering is one of the tools in our arsenal. We can provide you with custom solutions that are competitively priced and built to match the original design intent. Bring us your specifications and we'll get busy making you a riveting design!





# Custom Case Study

District 850



**Design Firm:** Dynamic Designs  
**Locations:** Tallahassee, Florida

District 850 is a family entertainment center with an arcade, laser tag, axe-throwing, bowling, ropes courses, escape rooms, party rooms and a full-service bar & restaurant. Venue worked very closely with the design firm and the owner to carefully specify and design furniture for every aspect of the facility.

Venue delivered a furniture package that was a mix of standard products, like Perfect Game sofas on the main lanes and Tribeca sofas on the VIP lanes, and purely custom pieces like the VIP lounge furniture and concourse furniture.

Dynamic Designs presented us with a clear direction of all the important design aspects. We worked with them to tailor a mix of custom & standard products that were within the owner's budget while satisfying the design intent. One example of this was the custom upholstered benches on the main bowling concourse. The owner and designer provided images of the aesthetic they were trying to achieve, and we designed a custom bench to seat 4 people while being space-efficient. The goal was to be able to accommodate different parties of guests by providing them space to sit back-to-back. The curvature of the bench was designed to create staggered seating, giving people more room & comfort.

INSPIRATION:

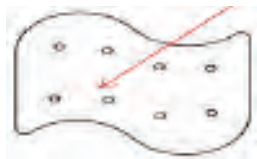

FINAL PRODUCT:



INSPIRATION:



FINAL PRODUCT:



INSPIRATION:



FINAL PRODUCT:



# Value Engineering



INSPIRATION



FINAL PRODUCT



INSPIRATION



FINAL PRODUCT



INSPIRATION



FINAL PRODUCT



## BOWLING SOFAS







## TRIBECA

VEN500-2120-D-96DT

American-Made, bowling sofa with diamond-tufting and optional ball racks on the side.



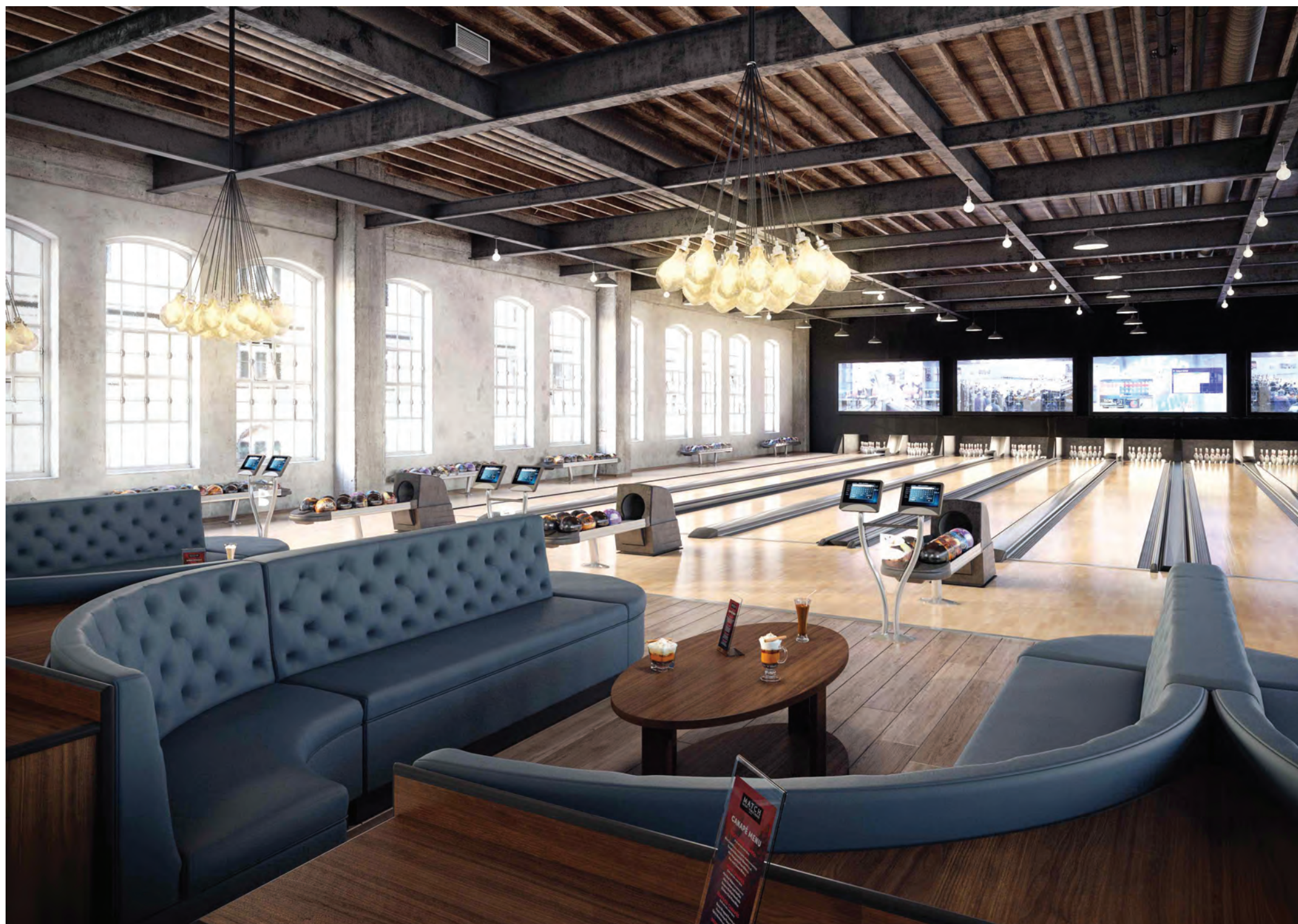

## PERFECT GAME

VEN500-2150

The bowling sofa that started it all. Many have tried to copy it but there is nothing like the original. The Perfect Game sofa is American-made, durable and built to be serviceable. Always built to order and available in any length.





## PERFECT GAME 2.0

VEN500-2560

A modernized version of the original, Perfect Game 2.0 incorporates metal legs and a laminated base to give it a unique look.





## ENCORE

VEN500-2900

The Encore line is the perfect fit for any modern interior. Encore is American-made, durable and built to be serviceable. Always built to order and available in any length.





## KENSINGTON

VEN500-2130-180

The Kensington maximizes the use of space,  
blending style and functionality.



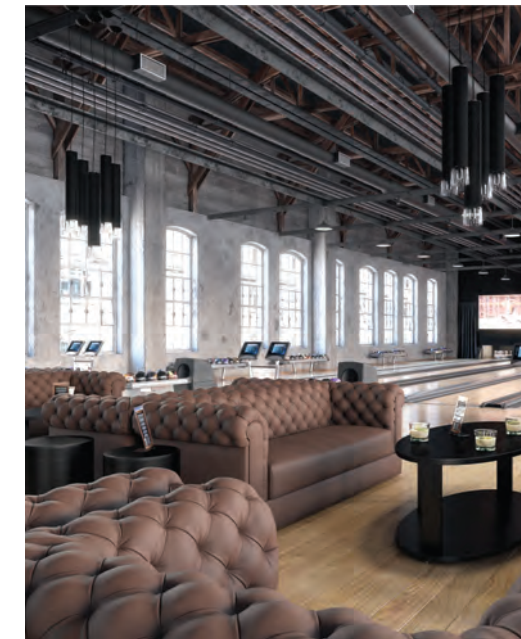

## WESTCHESTER

VEN500-2125

Modular seating system that allows for ever-changing, customizable seating arrangements. Choose from multiple sizes of ottoman to create your own layout.



## SOFAS & UPHOLSTERED CHAIRS





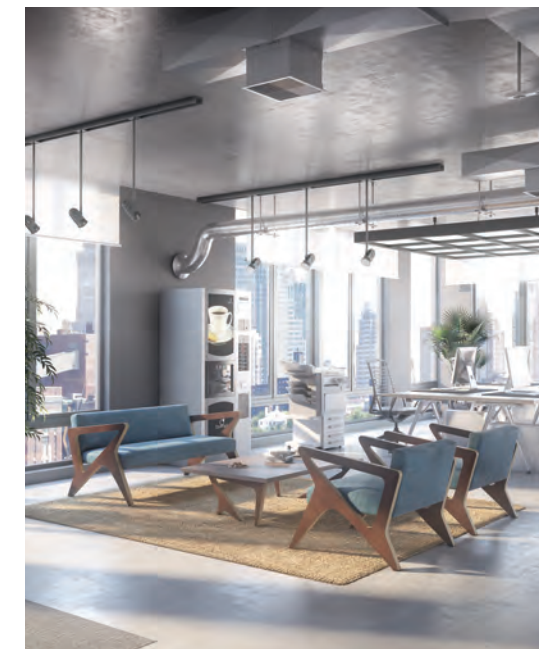

## ANASTASIA

VEN500-2256-27

American-Made loveseat & lounge chair with an upholstered web seat, and upholstered inside / outside back. Stained wood arms with exposed Russian plywood edge.





## LINK UP

VEN500-2277-33

Fully upholstered, American-Made chair, ideal for commercial office gathering spaces. Full box foam seat. Two tone upholstered seat & back. Available with a stationary base, swivel base or casters.



## SOFAS & UPHOLSTERED CHAIRS

Venue’s fully upholstered and customizable sofa & chair designs work well in a variety of settings. Choose traditional and refined or modern and edgy, our diverse array of upholstered seating can be used to complement any interior. Pair them, match them, or keep them solo. Our upholstered sofas and chairs enable you to create the ideal space for contract or hospitality spaces.



**Toledo**  
Dimensions: 48"W x 25"D x 42"H  
SKU: VEN500-2535-48S



**Akron**  
Dimensions: 54"W x 72"D x 55"H  
SKU: VEN500-2573-72D



**San Diego**  
Dimensions: 48"W x 27"D x 57"H  
SKU: VEN500-2520-72S



**Brickell**  
Dimensions: 103"W x 59"D x 58"H  
SKU: VEN500-2521



**Calabasas**  
Dimensions: 60"W x 26"D x 42"H  
SKU: VEN500-2514-60S-2



**Rebekah**  
Dimensions: 48"W x 26"D x 38"H  
SKU: VEN500-2155



**Sacramento**  
Dimensions: 27.5"W x 48"D x 33"H  
SKU: VEN500-2573-48S



**Youngstown**  
Dimensions: 62"OAW x 29.25"OAD x 53"H  
SKU: VEN500-2574



**Richmond**  
Dimensions: 64"W x 31"D x 54"H  
SKU: VVEN500-2571-64S









OTTOMANS

American-made ottomans, perfect for hospitality and contract environments. Use them in a traditional manor or as an alternative to traditional seating. Our wide variety of ottomans provides the simplest way to add character to your space with flexible seating options, brilliant designs, and versatility.



**Nola**  
Dimensions: 54"DIA x 18"H  
SKU: VEN500-2164-5454



**Bayport Swivel**  
Dimensions: 18"DIA x 24"H  
SKU: VEN500-2175-18R-S



**Garland**  
Dimensions: 20"DIA x 18"H  
SKU: VEN500-2167-2020



**Manhattan**  
Dimensions: 24"DIA x 18"H  
SKU: VEN500-2160-24R-C



**Florence**  
Dimensions: 35"DIA x 18"H  
SKU: VEN500-2177-35R



**Nevada**  
Dimensions: 26"DIA x 18"H  
SKU: VEN500-2161-26R



**Pebble**  
Dimensions: Visit Website for Dimensions  
SKU: VEN500-2184



**Vail**  
Dimensions: 19.3"DIA x 19.3"H  
SKU: VEN500-4161





BENCHES

Our upholstered benches are built with exceptional craftsmanship and style to compliment interior spaces such as an office lobby, hospitality facilities and contract environments. Upholstered benches are a resourceful way to create a unique seating area or an accent piece to add that final touch.



**Napa**  
Dimensions: 16.5"W x 60"D x 18"H  
SKU: VEN500-2171-1660



**Stockton**  
Dimensions: 20"W x 60"D x 19"H  
SKU: VEN500-2174-2060

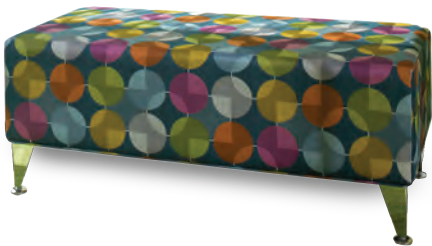

**Liberty**  
Dimensions: 44"W x 20"D x 18"H  
SKU: VEN500-2170-2044



**Arlington**  
Dimensions: 24"W x 60"D x 18"H  
SKU: VEN500-2172-2460



**Greco**  
Dimensions: 18"W x 52"D x 18"H  
SKU: VEN500-4120-1852-BN



**Chevron**  
Dimensions: 18"W x 52"D x 18"H  
SKU: VEN500-4130-1852-BN



**Cullman**  
Dimensions: 36"W x 96"D x 19"H  
SKU: VEN500-2182-96







BALL RACKS



## BALL RACKS

Our ball racks are customizable and can be built to any specifications. Our standard ball racks are built with powdercoated steel rods and are fully laminated with a vinyl t-mold edge.



**VEN650-Wedge Ball Rack**  
Dimensions: 56"W x 13.25"D x 30"H  
Ball Capacity: 12 balls



**VEN650-3BR-1696**  
Dimensions: 16"W x 96"D x 30"H  
Ball Capacity: 30 balls



**VEN650-2BR-2470-CH**  
Dimensions: 70"W x 24"D x 36"H  
Ball Capacity: 14 balls



**VEN650-3BR-1648**  
Dimensions: 48"W x 16"D x 30"H  
Ball Capacity: 15 balls



**VEN650-2BR-1896-BH**  
Dimensions: 90"W x 18"D x 90"H  
Ball Capacity: 20 balls



**VEN650-3BR-2490-BH**  
Dimensions: 48"W x 26"D x 38"H  
Ball Capacity: 24 balls



**VEN650-4BR-1896**  
Dimensions: 96"W x 18"D x 41.5"H  
Ball Capacity: 40 balls



**VEN650-2BR-1890-CH**  
Dimensions: 90"W x 18"D x 36"H  
Ball Capacity: 16 balls



**VEN650-2BR-1896-CH**  
Dimensions: 96"W x 18"D x 36"H  
Ball Capacity: 16 balls









BOOTHS  
& BANQUETTES

When it comes to booths and banquettes, nobody builds them better than Venue Industries. Each component is bolted to the next with metal to metal connections creating a frame that is serviceable and superior in quality. Any style, any size, we have you covered.



**Ipanema**  
Dimensions: 48"W x 25"D x 42"H  
SKU: VEN500-2535-48S



**Hannibal High**  
Dimensions: 54"W x 72"D x 55"H  
SKU: VEN500-2573-72D



**Cullman**  
Dimensions: 48"W x 27"D x 57"H  
SKU: VEN500-2520-72S



**Marion**  
Dimensions: 103"W x 59"D x 58"H  
SKU: VEN500-2521



**Winnie**  
Dimensions: 60"W x 26"D x 42"H  
SKU: VEN500-2514-60S-2



**Aldgate**  
Dimensions: 48"W x 26"D x 38"H  
SKU: VEN500-2155



**Presidio**  
Dimensions: 62"OAW x 29.25"OAD x 53"H  
SKU: VEN500-2574



**Colchester**  
Dimensions: 60"W x 24"D x 42"H  
SKU: VEN500-2570-60S



**Troy**  
Dimensions: 96"W x 28"D x 43"H  
SKU: VEN500-2522-96R







TABLES



TABLES

Our coffee tables, end tables, table tops, community tables and conference tables are American-made and can be customized to fit any interior. Metals can be powder coated any color and solid wood & wood veneers can be stained any color. Choose a natural material or an HPL with a variety of edge options.



Anastasia

Dimensions: 32"W x 48"D x 15.25"  
SKU: VEN500-2265-3248



Cardinal Oval

Dimensions: 30"W x 60"D x 20"H  
SKU: VEN500-4140-3060-OV



Leith

Dimensions: 120"W x 24"D x 42"H  
SKU: VEN500-4524



Perspective

Dimensions: Visit Website for Dimensions  
SKU: VEN200-VR



Ford

Dimensions: 96"W x 30"D x 42"H  
SKU: VEN500-4523



Greco

Dimensions: 18"W x 18"D x 20"H  
SKU: VEN500-4120-1818



Notus

Dimensions: 28"W x 42"D x 20"H  
SKU: VEN500-4121-2842



Chevron

Dimensions: 18"W x 18"D x 20"H  
SKU: VEN500-4130-1818









METAL CHAIRS & BARSTOOLS

If you're looking for the most durable seating in the industry, you've just found it. Our American-made metal chairs and barstools are commercial-grade and built-to-order. They can be powder coated in just about any color and custom upholstery options are available. Clean-lined and classic, our metal chairs and barstools are well-suited a wide range of interiors.



**Pittsburgh Barstool**  
Dimensions: 14"W x 14"D x 46"H  
SKU: VEN500-1605BS



**Annapolis Barstool**  
Dimensions: 17"W x 17"D x 43.5"H  
SKU: VEN500-809BS



**Portland Barstool**  
Dimensions: 16"W x 16"D x 43.5"H  
SKU: VEN500-100ABS



**Ladderback Arm Barstool**  
Dimensions: 17"W x 17"D x 43.5"H  
SKU: VEN500-BS-ARM



**Ladderback Dining Chair**  
Dimensions: 17"W x 17"D x 36"H  
SKU: VEN500-100DH



**Ladderback Chair**  
Dimensions: 17"W x 17"D x 32"H  
SKU: VEN500-100



**Harrisburg Barstool**  
Dimensions: 16"W x 17"D x 43.5"H  
SKU: VEN500-1608BS



**Harrisburg Chair**  
Dimensions: 16"W x 17"D x 32"H  
SKU: VEN500-1608



**Portland Chair**  
Dimensions: 16"W x 16"D x 32"H  
SKU: VEN500-1400





## WOOD CHAIRS & BARSTOOLS

Sit back in one of our built-to-order commercial wood chairs or barstools made from only the finest solid wood. Available in a wide variety of standard and custom finishes. Customize existing frame styles with frame modifications and/or custom upholstery. Elevate your space and its seating-style with a diverse selection of wood seating by Venue Industries.



**Lafayette**  
Dimensions: 18"W x 17"D x 47"H  
SKU: VEN575-9534BS



**Ladder Back Barstool**  
Dimensions: 18"W x 20"D x 43"H  
SKU: VEN500-155BS



**Kenosha**  
Dimensions: 16.9"W x 21.3"D x 40.1"H  
SKU: VEN100-024-40BH



**Hartselle**  
Dimensions: 20.3"W x 17.3"D x 32.8"H  
SKU: VEN100-004



**Pierre**  
Dimensions: 16.5"W x 18.1"D x 31.5"H  
SKU: VEN100-017



**Savannah**  
Dimensions: 21"W x 17.3"D x 33"H  
SKU: VEN100-008-34CH



**Norris**  
Dimensions: 20.8"W x 23.2"D x 34.2"H  
SKU: VEN100-006



**Santa Rosa**  
Dimensions: 19.7"W x 22"D x 44.5"H  
SKU: VEN100-009



**Provo**  
Dimensions: 17.7"W x 22.8"D x 35"H  
SKU: VEN100-022-35CH









OUTDOOR

Remarkably versatile, our commercial outdoor seating and table collections come in an array of materials including aluminium, wicker, teak and lightweight concrete. All products are made to withstand the elements and provide a timeless, stylistic touch to an environment.



**VEN550-ALE101**  
Dimensions: 16"W x 20"D x 45"H  
SKU: VEN550-ALE101



**VEN550-SAN101**  
Dimensions: 25.5"W x 24.5"D x 27.5"H  
SKU: VEN550-SAN101



**VEN550-SAR103**  
Dimensions: 78.5"W x 26.5"D x 30"H  
SKU: VEN550-SAR103



**VEN550-ELL302**  
Dimensions: 23.5"W x 22"D x 32.25"H  
SKU: VEN550-ELL302



**VEN550-INT401**  
Dimensions: 21.5"W x 19"D x 34"H  
SKU: VEN550-INT401



**VEN550-SLU302**  
Dimensions: 22.5"W x 21.25"D x 33.5"H  
SKU: VEN550-SLU302



**VEN550-LOU301**  
Dimensions: 19.25"W x 20.5"D x 31.5"H  
SKU: VEN550-LOU301



**VEN550-MRT302**  
Dimensions: 19"W x 21.5"D x 33.5"H  
SKU: VEN550-MRT302



**VEN550-SAN305**  
Dimensions: 60"DIA x 30"H  
SKU: VEN550-SAN305





MILLWORK

We offer custom millwork for commercial and residential spaces. We can design, but are not limited to: credenzas, media centers, executive offices, lecterns, desks, cabinets and storage systems.







## CONTACT US

---

### VENUE INDUSTRIES

3212 N. 40th Street, Suite 103B  
Tampa, FL 33605



1-855-55VENUE (1-855-558-3683)



[sales@venueindustries.com](mailto:sales@venueindustries.com)